

# OPERATION MANUAL Model SH00 **St One** (Steve One)

THIS SHARPENSET IS A HANDCRAFTED MACHINE – BUILT WITH LOVE FOR TECHNOLOGY



Sharpenset Engineering  
Since 1956

[www.sharpenset.com](http://www.sharpenset.com)

Please register your **Serial number** and company name on [info@sharpenset.com](mailto:info@sharpenset.com)  
(Warranty period)

property by Sharpenset Engineering  
[www.sharpenset.com](http://www.sharpenset.com)

## **WARNING**

### **THIS APPLIANCE MUST BE EARTHED**

#### **IMPORTANT**

The wires in the mains lead are coloured in accordance with the following code:-

Green and Yellow	-	Earth
Blue	-	Neutral
Brown	-	Live

As the colours of the wires in the mains lead of this appliance may not correspond with the coloured markings identifying the terminals in your plug, proceed as follows:-

The wire which is coloured green and yellow must be connected to the terminal in the plug which is marked with the letter 'E' or by the earth symbol  $\perp$  or coloured green or green and yellow.

The wire which is coloured blue must be connected to the terminal which is marked with the letter 'N' or coloured black.

The wire which is coloured brown must be connected to the terminal which is marked with the letter 'L' or coloured red.

# THE SHARPENSET WHETSTONE GRINDING MACHINE

## C.O.S.H.H. SAFETY DATA

*PLEASE READ THIS INFORMATION THOROUGHLY, NOTE ITS CONTENT AND FILE FOR FUTURE REFERENCE.*

### GENERAL COMMENTS

The Sharpenset Whetstone Grinding Machine is a water cooled, commercial grinding machine. As with all grinding machines, certain codes of practice must be observed in the interests of safety. Following the rules listed below will greatly reduce the risk of hazard and improve safety.

### HAZARDS

#### 1) Grindstone

This is a balanced, bonded cylindrical cup wheel, mounted on an aluminium faceplate. When replacing, care should be taken to ensure the stone runs true. An out of true stone is dangerous and should be trued up, or removed. Dressing the stone with a suitable dressing stick is advised to avoid loading. All broken, or cracked stones should be removed and discarded.

**N.B. If the stone has come adrift from its faceplate, never attempt to affix it in any way.**

Although being water cooled, which reduces dust and debris considerably, it is still recommended that eye protection and gloves should be worn when operating the machine. For further information, reference should be made to the abrasive wheel regulations leaflet enclosed.

#### 2) Water

The fractional horsepower motor and switch, fully earthed, housed in the body casting, is protected from the water in the water bath by a metal to ceramic seal. Should the water at any time penetrate the seal, fitted below is a rotary watershield which will temporarily 'throw off' the water from the motor and drips will show at the 'tell tale' hole situated at the rear of the machine. In this event, immediately disconnect the mains supply and seek a competent engineer to fit a new seal.

#### 3) Electrics

A 16 amp fuse should always be fitted and the supply disconnected when alterations, attachments fitted, cleaning or any other adjustments to the machine are carried out.

#### 4) Cleaning

Remember to disconnect the mains supply. It is recommended the water bath is cleaned out regularly, at least twice a week, to reduce the risk of water contamination. **Do not use any cleaning agent, chemical or hot water when cleaning this machine** – use cold fresh water only. The exterior of the machine should be wiped over with a damp cloth. **Never use high pressure hoses or sprays** in the vicinity of the machine, as this can lead to electrical failure.

#### 5) General Maintenance

Although the machine requires very little maintenance, it is recommended that should any be required, that it is carried out by the manufacturer, or a competent engineer.

6) Should you have any queries regarding the above, please do not hesitate to contact us.

# INSTRUCTIONS FOR USE OF THE SHARPENSET WHETSTONE KNIFE SHARPENING MACHINE

## IMPORTANT NOTICE

### PROTECTIVE GLOVES AND EYE GOGGLES SHOULD ALWAYS BE WORN WHEN GRINDING

**Remove all packing from underneath machine around motor before operating.**

- 1) **Most important**, the machine should never be run dry. Fill the water trough to the top of the water inlets in the inner walls of the trough.
- 2) Fix the copper delivery tube so that the water will flow onto the stone as required.
- 3) Before switching on the motor be sure that the **guide** is clear and not pressing on the stone..
- 4) Ensure that knives and choppers are clean and free of grease.
- 5) Moving the switch to the left rotates the stone clockwise, turning it to the right rotates it anti-clockwise. When changing the running direction of the stone **WAIT UNTIL THE STONE IS STATIONARY** and then direct to position required.
- 6) When the stone becomes worn, lower the guide by releasing the thumb screw on the adjustment pillar at the back of the machine and then re-tighten once in position.
- 7) To replace the stone, remove the guide, unscrew the hexagon headed locking screw in the metal face plate carrying the stone, insert a screwdriver each side and gently lever off the old stone. Fit new stone and replace screw.
- 8) Clear silt from the water bath as necessary (say once a week).  
**N.B. Do not use any type of chemical cleaner when cleaning out the water bath**

## POSITIVE SHARPENING

Positive sharpening means that anyone can be absolutely certain that the knife has been perfectly sharpened throughout its length without even 'feeling' it.

Begin sharpening the knife on the right hand side of the stone and with the stone running towards it (i.e. clockwise). This backs the knife against the guide and maintains the correct angle. Traverse the knife some dozen times across the stone following the curve of the knife towards its tip and then examine it by tilting the flat of the blade towards the light. You will readily see where it has been freshly ground and if you look closely you will find a narrow white line running along the knife edge. This shows that the sharpening has not yet reached the edge. Carry on sharpening at the same angle and inspecting the knife as before. When you have reached the edge at any part, leave that part and attend to the remainder until the knife has been sharpened to the edge throughout its length on that side. Reverse the direction of the stone and proceed with the other side, but now using the left hand side of the stone. Now tilt the edge of the knife towards the light. The white line should be invisible. If you can see any part of a white line, determine on which side of the knife it lies and sharpen on that side. When you are satisfied you may be quite certain that the knife has been perfectly sharpened.

To remove the shoulder proceed as above, but with the knife advanced away from you so that in fact you are using a shallower angle and the guide simply becomes a rest. Your object should be to blend the sharpened edge nicely into the face of the blade. Finish on the steel.

There are a few points it is as well to have in mind:-

In the final stages of sharpening the edge, use only light pressure, heavy pressure results in a turned edge with the stone running towards it or a feather edge with the stone running away from it. Either is easily removed on the steel.

The first sharpening of a knife whether new or used may take some twenty minutes, but afterwards a minute or two whenever required should be sufficient in the case of the average butcher.

**POSITIVE SHARPENING is only feasible with the SHARPENSET WHETSTONE.**

**SHARPENSET ENGINEERING BV**

[www.sharpenset.com](http://www.sharpenset.com)

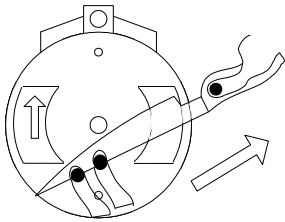

Step 1

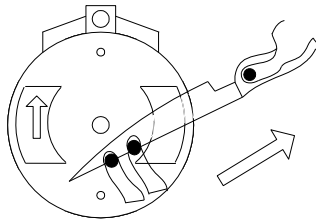

Step 2

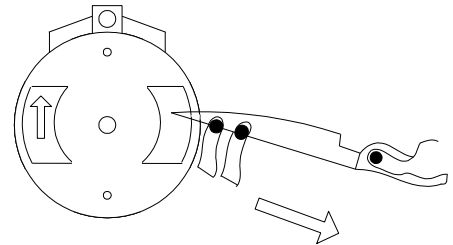

Step 3

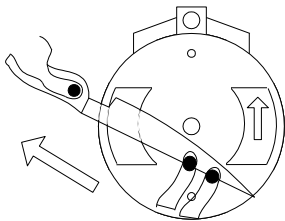

Step 4

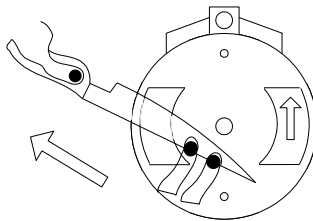

Step 5

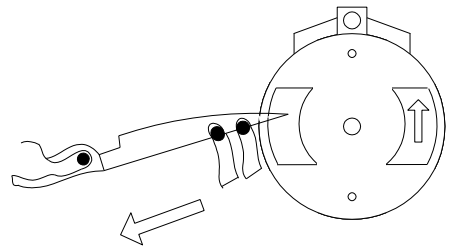

Step 6

Before proceeding, read the following instructions carefully.

To sharpen a knife on the right hand side of the stone, turn the switch so that the stone is running in a clockwise direction. The stone will then be travelling towards the edge of the blade. Follow steps 1 - 3:

1) Take the knife in your right hand and present the blade to the guide so that it is flat against the 7.5 degrees (shallow) angle, at approximately 20 degrees off the horizontal. 2/3) Draw the knife across the stone, following the curve of the blade from the hilt to the tip. Continue this until the desired edge is achieved.

N.B. To help balance the knife as you draw it across the stone, place your fingers on the flat of the blade at the tip of the knife.

To sharpen the other side of the blade turn the switch to the opposite direction and follow steps 4-6 and work on the left hand side of the stone.

## **SPECIFICATION OF THE SHARPENSET WHETSTONE KNIFE GRINDING MACHINE**

Sharpenset Whetstone Machine	A robust, portable, electrically powered, water-cooled machine. Constructed of durable aluminium castings, with all exposed parts being completely rustproof. One of the features of this machine is 'wet grinding', which prevents grinding dust and does not draw the temper of the steel.
Machine Details	Height : 40cm Width : 28cm Depth : 30cm
Voltage/Hz/Phase	220/240 Volts, 50Hz, Single Phase Fitted with 16 amp plug. 110v/60hz available to order.
Colour/Finish	Blue stove enamel, hammer finish.
Shipping Details	Gross weight each carton : 14kg Nett weight each machine : 11.5kg



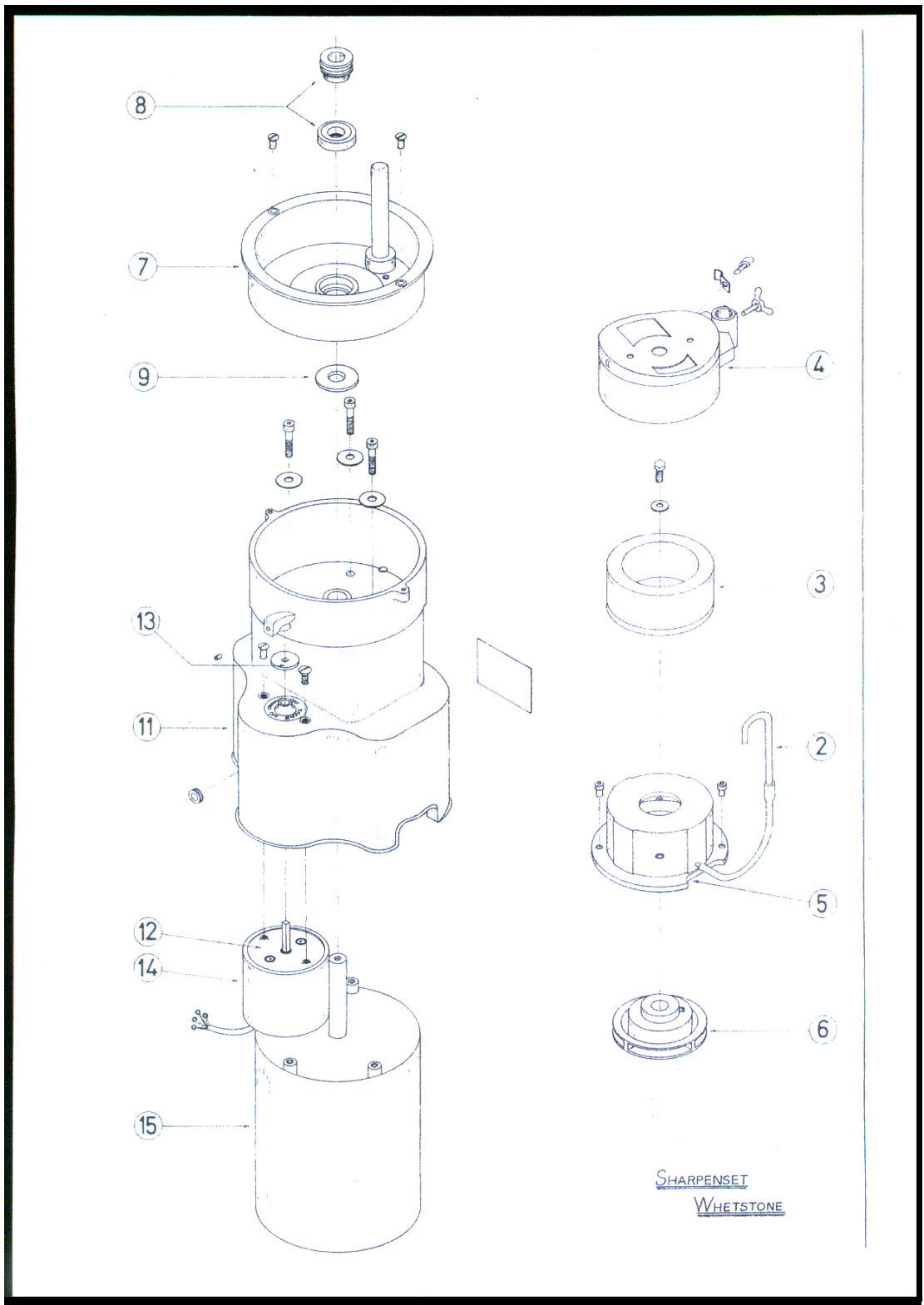

- |    |                   |             |     |                    |             |
|----|-------------------|-------------|-----|--------------------|-------------|
| 1. | Adjustment Pillar | <b>SH01</b> | 9.  | Rotary Watershield | <b>SH09</b> |
| 2. | Water Feed        | <b>SH02</b> | 11. | Body               | <b>SH11</b> |
| 3. | Stone & Faceplate | <b>SH03</b> | 12. | Rotary Switch      | <b>SH12</b> |
| 4. | Guide and Ring    | <b>SH04</b> | 13. | Switch Washers     | <b>SH13</b> |
| 5. | Impeller Housing  | <b>SH05</b> | 14. | Switch Cover       | <b>SH14</b> |
| 6. | Impeller          | <b>SH06</b> | 15. | Motor              | <b>SH15</b> |
| 7. | Water Bath        | <b>SH07</b> |     |                    |             |
| 8. | Seal              | <b>SH08</b> |     |                    |             |



DECLARATION OF CONFORMITY

---

Manufacturer: **Sharpenset Engineering BV Belgium – [www.sharpenset.com](http://www.sharpenset.com)**

e-mail : [info@sharpenset.com](mailto:info@sharpenset.com)

Description of product :

SHARPENSET WHETSTONE KNIFE SHARPENING MACHINE

Serial No's. ...22000 - up to - 22400 .....

Conforms to :

Control of Substances Hazardous to Health (C.O.S.H.H.) Regulations 1988

Abrasive Wheel Regulations 1970, No. 535.

Control Switch : CA10, ISO 9002, EN29002, B.S. 5750.

Motor : B.S. 5000/11 and B.S. 2206.

Water Seal : B.S. 5750, ISO 9000.

Castings : B.S. 1490 LM6 and 4L33.

Date .... 10/06/2021

Signed .....

Name : Harold Demoen

For and on behalf of Sharpenset Engineering BV



## **PLEASE READ CAREFULLY**

### **INSTRUCTIONS FOR CHANGING THE STONE ON THE SHARPENSET WHETSTONE**

1. Upon delivery, the stone must be carefully inspected to ensure that no damage has occurred in transit.
2. To replace the stone, remove the guide, unscrew the hexagon headed locking screw in the metal face plate carrying the stone, insert a screwdriver or similar each side under the metal face plate and gently lever the old stone off of the motor shaft.
3. Thoroughly clean the motor shaft with emery cloth, ensuring that there are no burrs on the shaft or the keyway. (Apply a small amount of grease to the shaft before fitting the new stone)
4. Fit new stone, locating the grub screw in the keyway on the motor shaft and replace the hexagon headed screw and tighten into position. (The new stone should fit onto the motor shaft easily)
5. Re-fit the guide and locate just slightly above the stone so that there is clearance and it is not touching the stone.
6. **Any failure to follow the above procedure and thus causing damage to the stone, will invalidate any obligation on the part of Sharpenset Engineering in respect of replacement or credit for said damage.**
7. If you experience any difficulties, please do not hesitate to contact us.

#### **SHARPENSET ENGINEERING BV**

**e-mail :[info@sharpenset.com](mailto:info@sharpenset.com) Website : [www.sharpenset.com](http://www.sharpenset.com)**



Sharpenset Engineering  
Since 1956



Sharpenset Engineering  
Since 1956

**Type AMAS-R 63B4**

**IM B3 0,18 kW 230V 50Hz**

**1380 RPM 1,4 A**

**Ins.Cl F IP 55**

**10  $\mu$ F 450 V**

**Running Capacitor**

SEAL ASSEMBLY  
TYPE 106 - 5/8" SHAFT

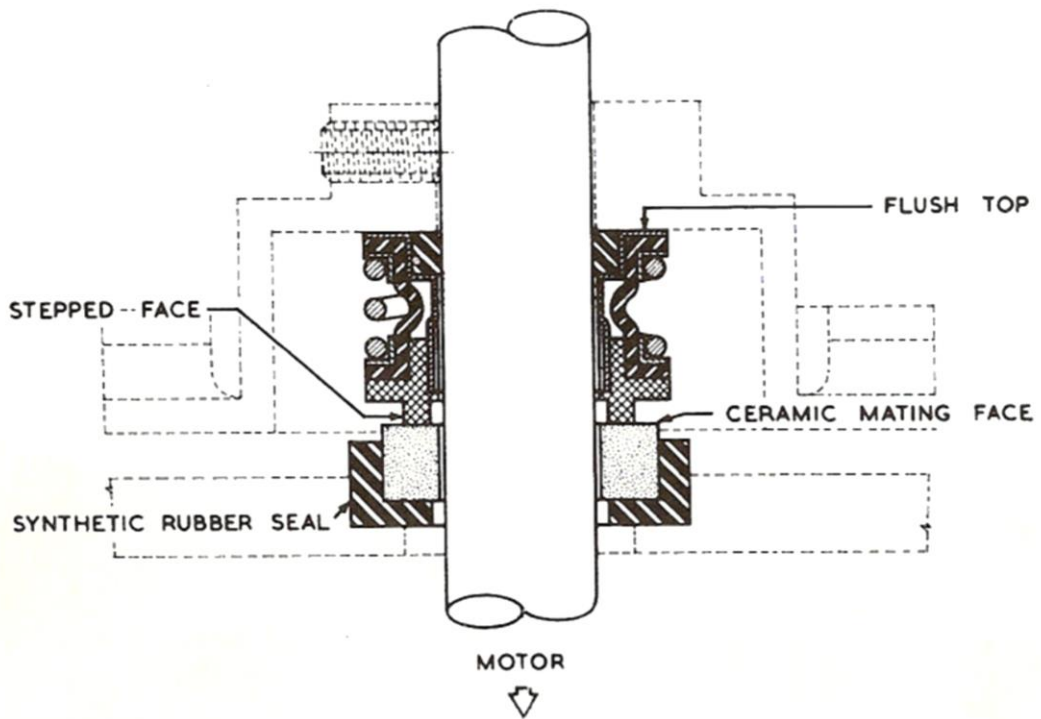

Sharpenset Engineering  
Since 1956

# WARNING

## THIS APPLIANCE MUST BE EARTHED

### IMPORTANT

The wires in the mains lead are coloured in accordance with the following code:-

Green and Yellow	-	Earth
Blue	-	Neutral
Brown	-	Live

As the colours of the wires in the mains lead of this appliance may not correspond with the coloured markings identifying the terminals in your plug, proceed as follows:-

The wire which is coloured green and yellow must be connected to the terminal in the plug which is marked with the letter 'E' or by the earth symbol  $\perp$  or coloured green or green and yellow.

The wire which is coloured blue must be connected to the terminal which is marked with the letter 'N' or coloured black.

The wire which is coloured brown must be connected to the terminal which is marked with the letter 'L' or coloured red.



Sharpenset Engineering  
Since 1956

Fit Motor Shaft as usual, you will probably have to remove the old terminal box for this.

If using a 93mm long shaft, fit 2mm short of the shoulder on the 11mm Motor Shaft

Cut 4 off 145mm x M4 Studs – you need plenty of M4 nuts & washers to suit.

Remove the cowling at the rear of the motor and remove the existing Motor bolts

Replace with the M4 studs. Do not replace the cowling until you have locked the studs in properly.

You need each stud and nuts aiming for the stud to protrude 18mm above the nut

On each M4 Stud at the motor shaft end put a washer, 2 M6 nuts as spacers to support the tufnol motor plate.

Fit the altered Tufnol Motor Plate with the single helicoil at 3 o'clock to the terminal box and the 95 diameter toward the motor

Another washer on each stud then an M4 nut. Tighten all the studs one by one, do not over tighten till all have a grip.

Wire up the motor as per wiring instructions. The earth wire will need to be 330mm long. Using a 6 point terminal block.

Fit the altered Terminal box. Once you have tapped the motor fixing holes.

The terminal box will need the fixing holes altered using a drill or mill to 53mm.

Test Motor using a transformer (for Europe – not USA)



Sharpenset Engineering  
Since 1956

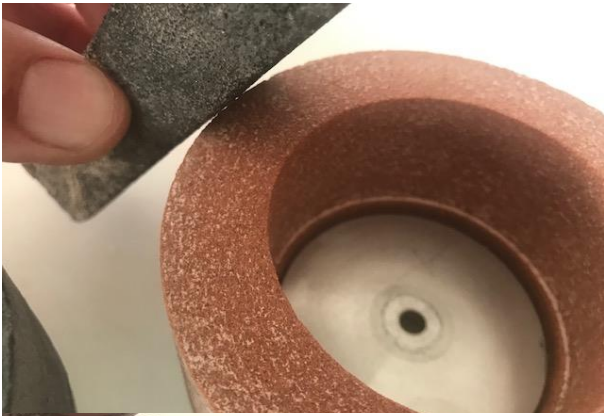

Dressing stick  
Extend the lifetime of your  
stone.  
150 grit orange  
280 grit grey